

MASONRY PROJECT #40

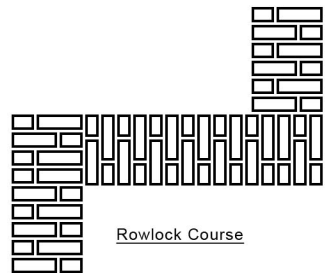
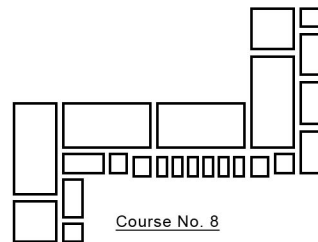
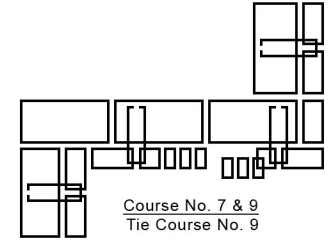
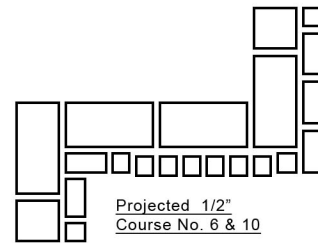
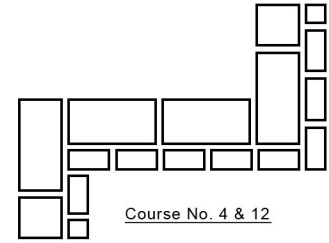
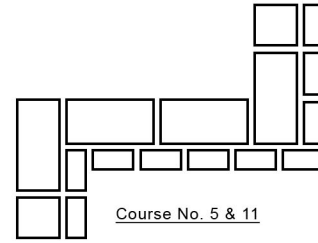
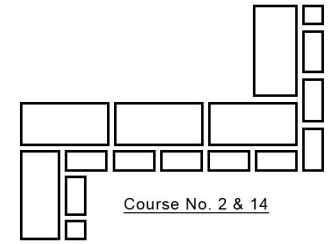
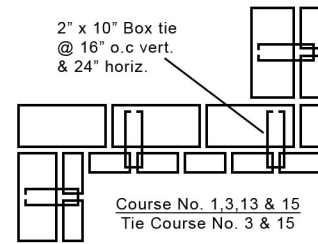
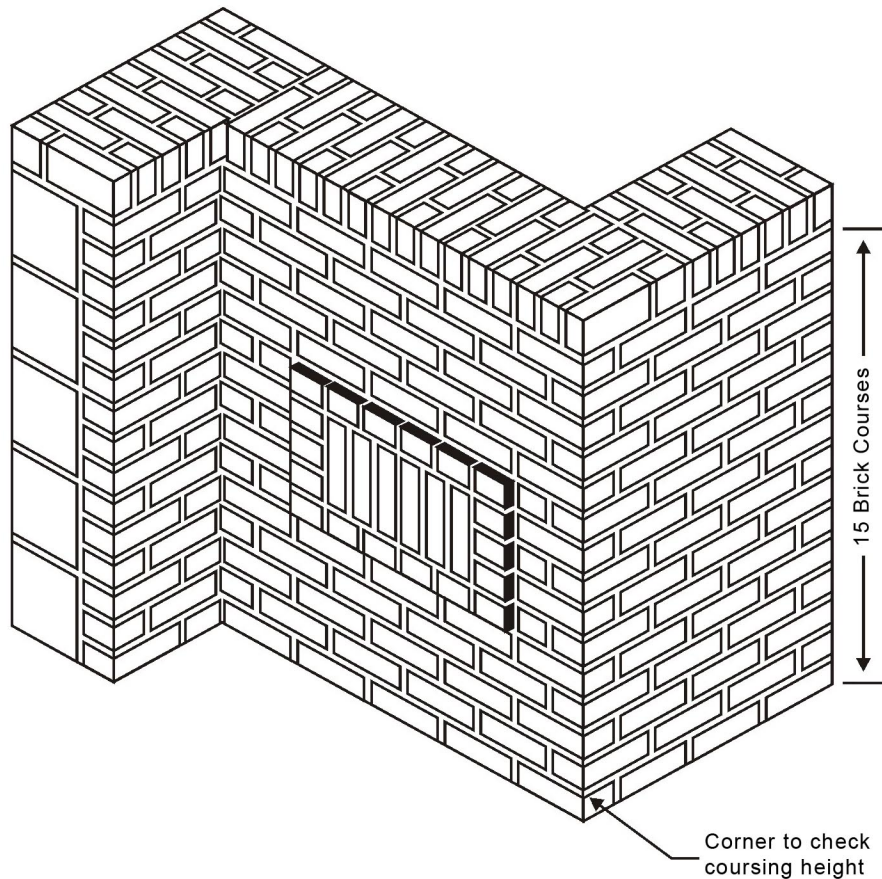

**Bon Tool Co. does not guarantee the accuracy of the data.
Please report errors and submit suggestions to Bon Tool Co.**

INSTRUCTIONS

1. Build wall as shown.
2. First course of brick to be used to level project.
3. Brick coursing to be 3 in 8" from top of first course up.
4. Fill all head, bed and joints.
5. Panel with soldier brick to be projected 1/2".
6. Both sides and ends to be finished with concave joint.
7. Cleaning to be by brushing only.

Bon Tool Co.

Gibsonia, PA 15044 • USA • 724-443-7080 • www.bontool.com