

Bon[®]

**AVAILABLE
NOW**

Chicago Hand & Walking Groovers



HAND GROOVERS

- *Stainless steel construction*
- *Equipped with Wood Wave handle*
- *Available in 8" x 8" and 10" x 10"*

PART #	SIZE	BIT	HANDLE
82-930	8" x 8"	3/8" x 1/2"	WOOD
82-931	8" x 8"	3/8" x 5/8"	WOOD
82-932	8" x 8"	1/2" x 3/4"	WOOD
82-933	8" x 8"	3/4" x 7/8"	WOOD
82-934	10" x 10"	1/2" x 3/4"	WOOD
82-935	10" x 10"	3/4" x 7/8"	WOOD

WALKING GROOVERS

- *Stainless steel construction*
- *Bull float bracket attached (#12-171) and ships assembled*
- *Fits Bon bull float handles w/button attachment*



PART #	SIZE	BIT	W/BRACKET
82-950	8" x 8"	3/8" x 1/2"	#12-171
82-951	8" x 8"	3/8" x 5/8"	#12-171
82-952	8" x 8"	1/2" x 3/4"	#12-171
82-953	8" x 8"	3/4" x 7/8"	#12-171
82-954	10" x 10"	1/2" x 3/4"	#12-171
82-955	10" x 10"	3/4" x 7/8"	#12-171

WALKING GROOVERS INTERCHANGEABLE WITH BON'S UNIVERSAL BRACKETING SYSTEM

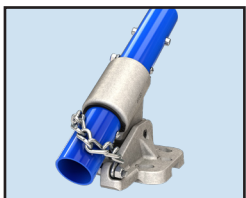

#12-372
Wormgear

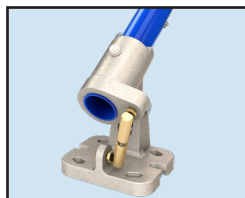

#12-946
Rock 'n Roll

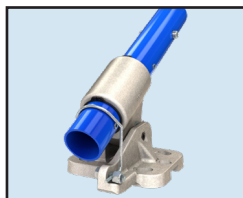

#12-263
Rite-Height
w/Cable

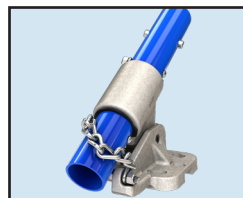

#12-272
Rite-Height
w/Chain



#12-376
Universal
Threaded

To place an order 800-444-7060 • sales@bontool.com

PS82930 10/2023